

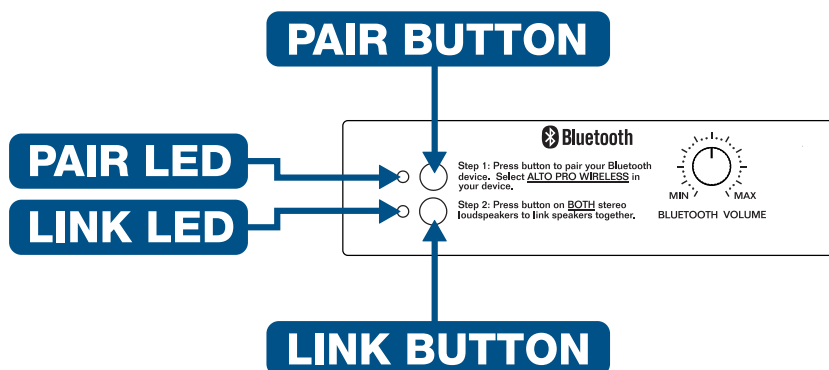

READ ME FIRST IMPORTANT BLUETOOTH SET-UP INSTRUCTIONS

TO SET-UP 2 LOUDSPEAKERS (STEREO):



- 1** Choose a **MASTER** loudspeaker.
MASTER can be either loudspeaker. Be sure to choose only one. The remaining speaker will be the SLAVE.
- 2** Press and release **PAIR BUTTON** on the **MASTER** loudspeaker *only*.
You should hear a tone repeat once every second; the PAIR LED will flash. Move to Step 3.
- 3** Select **ALTO PRO WIRELESS** on your Bluetooth audio device.
- 4** Wait for device to pair. This may take a while (roughly 60 seconds or longer).
When successfully paired, the tones will stop and the PAIR LED will light solid. If the device fails to connect try steps 2 and 3 again.
- 5** Press and release **LINK BUTTON** on **MASTER** loudspeaker first.
The LINK LED will flash and you will hear a repetitive tone sequence (beep beep). If this does not work, wait 5 seconds and press the button again.
- 6** Press and release **LINK BUTTON** on **SLAVE** loudspeaker.
The LINK LED will flash and you will hear a repetitive tone sequence (beep beep). If this does not work, wait 5 seconds and press the button again.
- 7** Wait for **MASTER** and **SLAVE** to link.
When successfully linked, the tones will stop and the LINK LEDs will light solid on both speakers. If they do not link after 2 minutes, power both loudspeakers off, then back on and return to step 2.
- 8** Play Music.

NOTE, IF YOU ARE EXPERIENCING PROBLEMS: (1) Reset your loudspeakers by pressing and holding the bottom LINK BUTTONS on each loudspeaker for 3 seconds until you hear a long tone from each. (2) On Your Bluetooth device, select "Forget" or "Unpair" ALTO PRO WIRELESS. (3) Repeat steps 1-8.

TO SET-UP 1 LOUDSPEAKER:

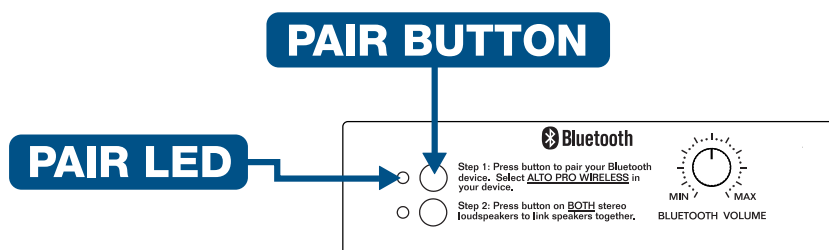

- 1** Press and release **PAIR BUTTON** on the loudspeaker.
You should hear a tone repeat once every second; the PAIR LED will flash. Move to Step 3.
- 2** Select **ALTO PRO WIRELESS** on your Bluetooth audio device.
- 3** Wait for device to pair. This may take a while (roughly 60 seconds or longer).
When successfully paired, the tones will stop and the PAIR LED will light solid. If the device fails to connect try steps 2 and 3 again.
- 4** Play Music.

NOTE, IF YOU ARE EXPERIENCING PROBLEMS: (1) Reset your loudspeaker by pressing and holding the bottom LINK BUTTON for 3 seconds until you hear a long tone. (2) On Your Bluetooth device, select "Forget" or "Unpair" ALTO PRO WIRELESS. (3) Repeat steps 1-4.

TO RECONNECT AFTER POWER OFF/ON:

MASTER and SLAVE loudspeakers will reconnect automatically. On your Bluetooth audio device, pick **ALTO PRO WIRELESS** and press connect.

For instructional video and FAQs visit:

altoprofessional.com/wireless